

Rinnai

Multi-function box installation (CNTRLMFB)

The multi-function box is an accessory that allows the Pro Series High Wall heat pumps to be connected to a standard wired wall controller, allowing additional functionality such as full wireless control.

Compatible wired wall controller:

- Standard controller: CNTRLDRGINW

Installation

1. Open the high wall heat pump front panel.
2. Remove the LED display box cover.
3. Remove PCB cover and locate wiring port of CN32 (Multifunction) on PCB.
4. Attach Multi-Function box wiring into PCB and into LED display.
5. Attach Multi-Function box and wiring inside heat pump cover, refer photo on next page.
6. Check operation.

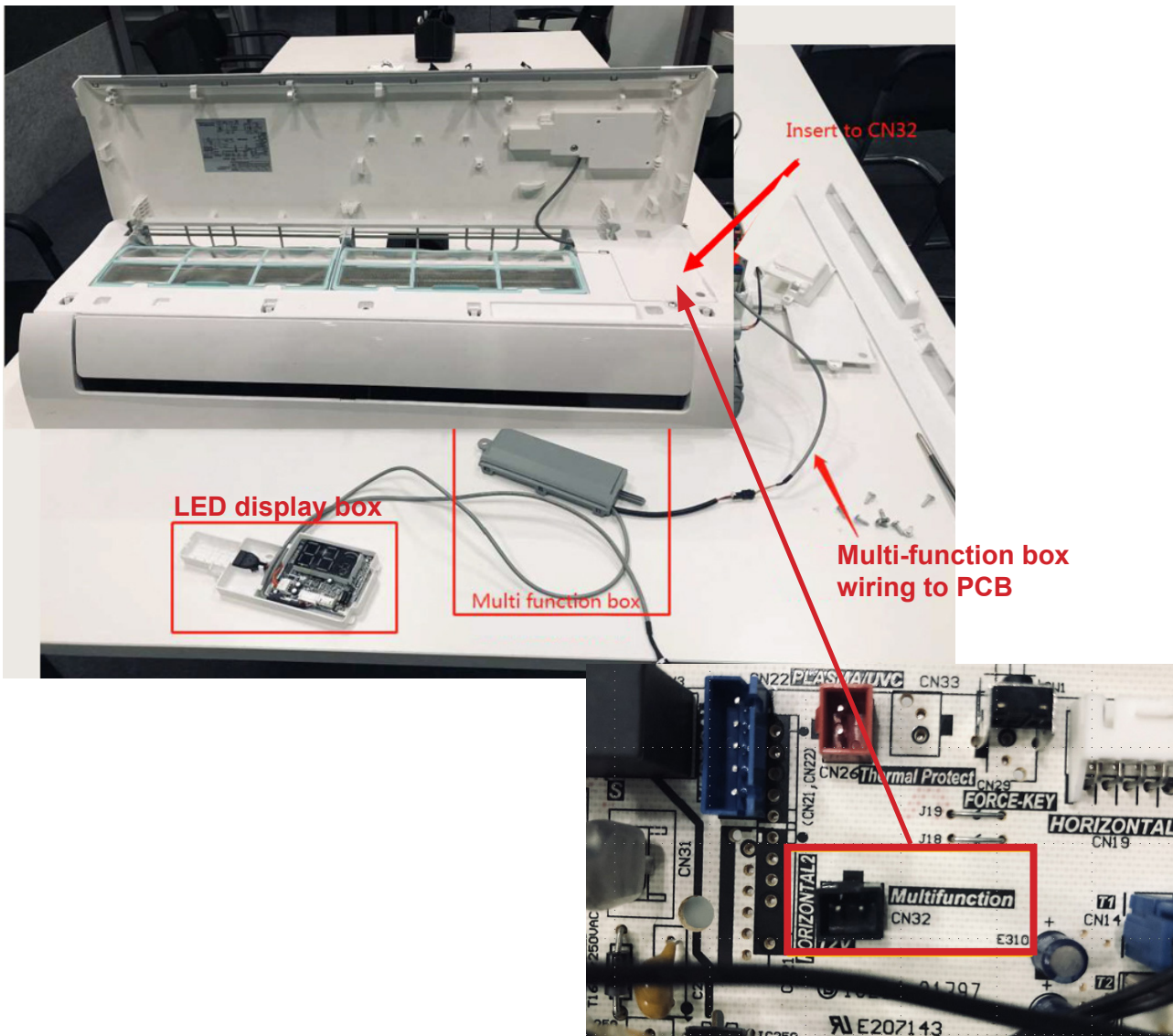

Rinnai

Multi-function box installation (CNTRLMFB)

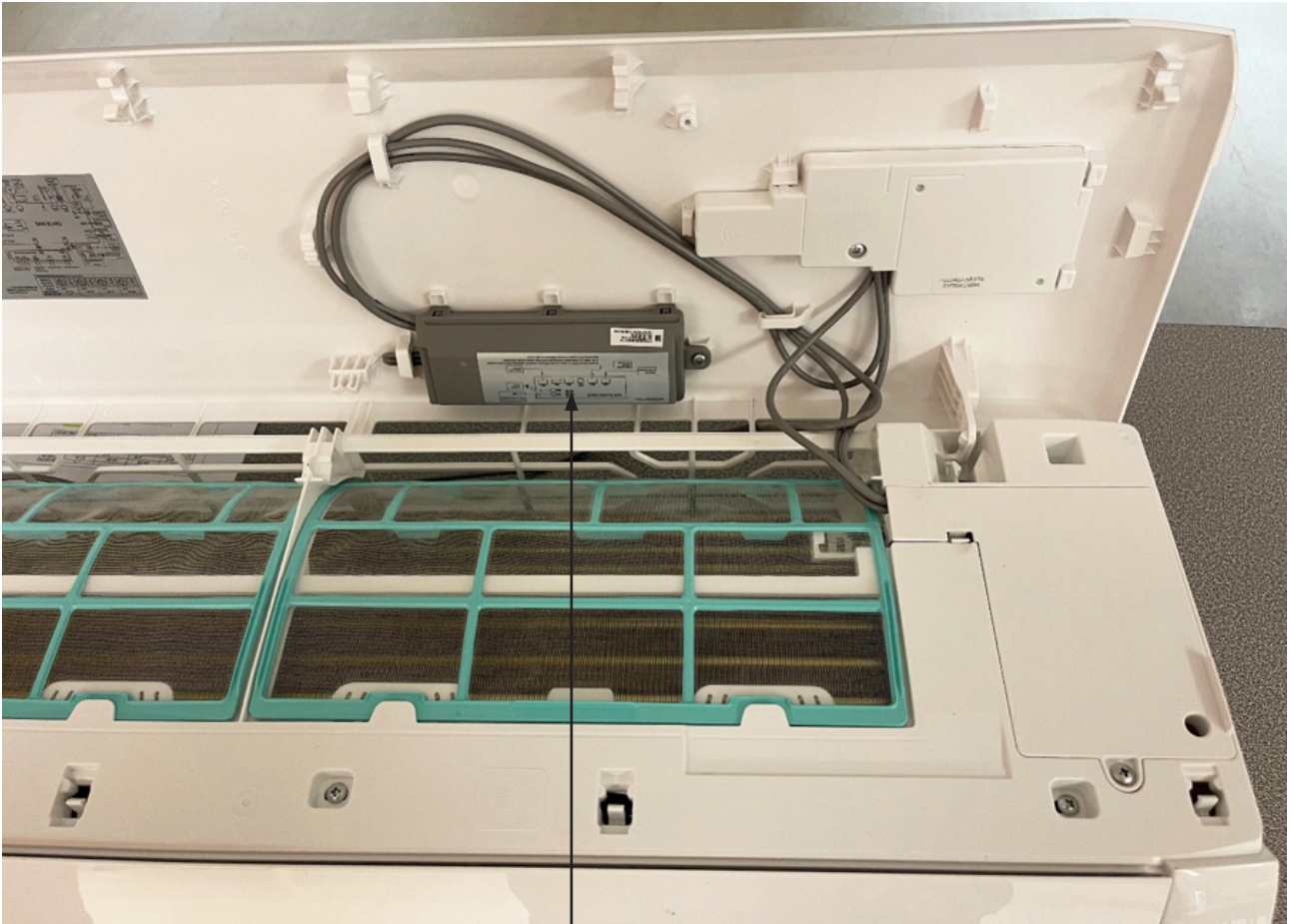

Multi-Function box installed