

This diagram is provided to assist you to identify parts if replacement is necessary. Contact your place of purchase or the manufacturer to enquire about parts, availability and/or service.

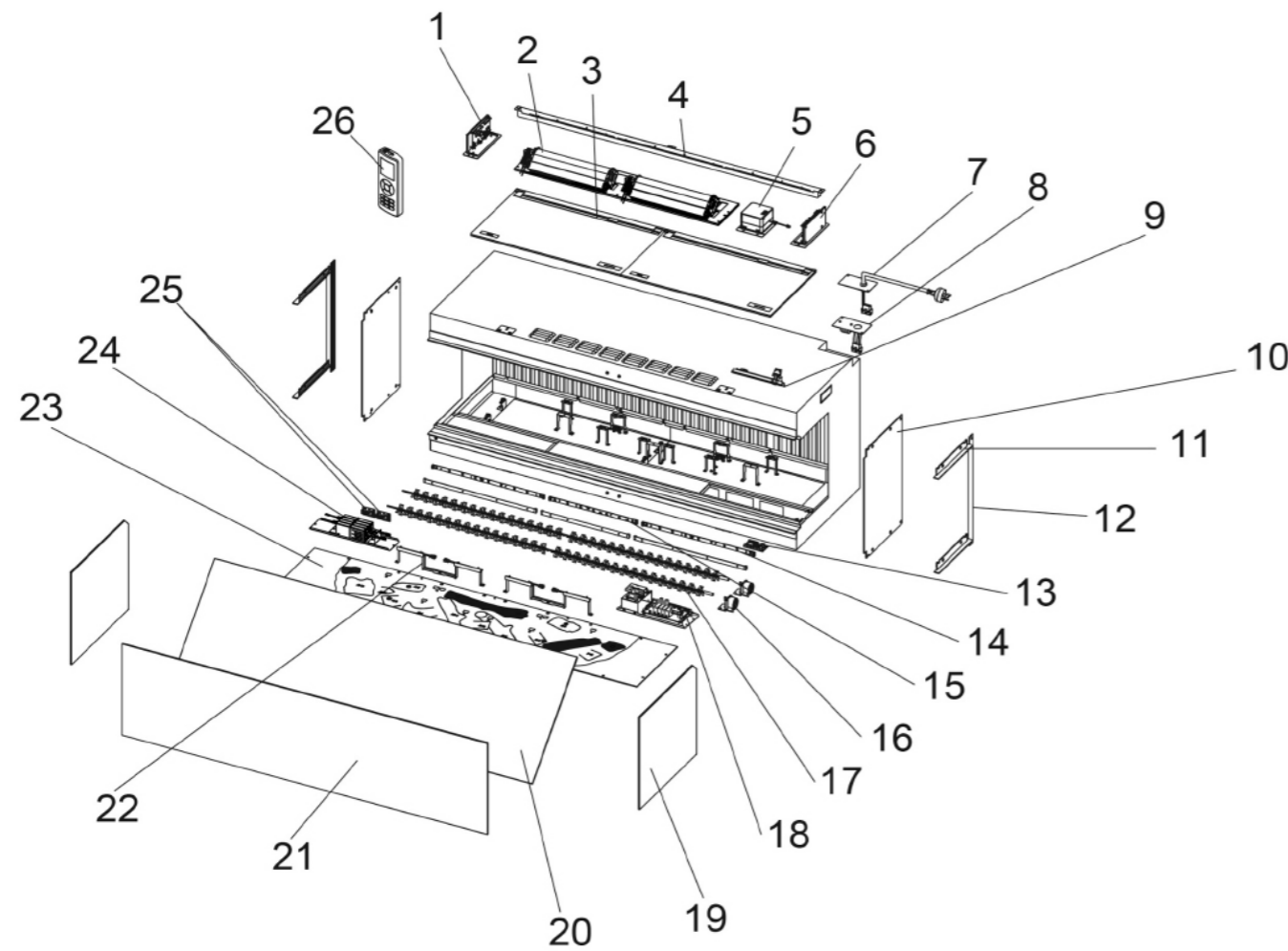

Ref.	Description	Part No.
1	Left LCD driver	
2	Heater unit	17935
3	LCD panel	
4	Down light	
5	Speaker	
6	Right LCD driver	
7	15 A power cord	
8	Hard wire inlet board	
9	Manual control panel	
10	Side panel	
12	Side trim	
13	Log LED PCB	
14	Fuel bed LED board B	
15	Fuel bed LED board A	
16	Spindle motor	
17	Fuel bed effect spindle	
18	Main PCB	
19	Side glass	
20	Flame screen	17936
21	Front glass	17937
22	Fuel bed up lights	
23	Fuel bed panel	
24	Power unit	
25	Interface board	
26	Remote	17938

FUEL BED SPARES	
Description	Part No.
AI-2 log	17919
AI-1 log with connector	17920
AI-3 log with connector	17921
AI-4 log with connector	17922
AI-7 log	17908
AI-8 log	17909
AI-10 log	17923
AI-5 log with connector	17924
AI-6 log with connector	17925
AI-9 log with connector	17926
P-10 log	17928
AD-8 log	17929
AA-16 log	17930
X-14 log	17931
AI-11 log	17932
AI-12 log	
AI-13 log	17933
P-13 log	17934
P-15 log	
G-2 log	
G-3 log	17939

