

## Operation Manual



For Rinnai continuous flow water heaters manufactured from 2010 onwards  
(serial number 09.12—xxxxxx)

- Internal Rinnai continuous flow water heaters must be installed with an approved Rinnai flue system
- Appliance must be installed, commissioned and serviced by a licensed tradesperson in accordance with these instructions and all applicable local rules and regulations
- Models are not suitable as a spa or swimming pool heater
- Owner, please retain this manual for future reference
- All gas appliances require regular servicing

**Installer, please leave this manual with the owner**

# LIMITED WARRANTY

## The Rinnai Warranty

Rinnai offers you real peace of mind with comprehensive warranty plans covering parts and labour. For full details on Rinnai product warranties go to [www.rinnai.co.nz](http://www.rinnai.co.nz).

This warranty is applicable to all Rinnai continuous flow water heaters installed from 2010. All terms of the warranty are effective from the date of installation.

## Warranty Summary

Rinnai Continuous Flow Water Heater	Application	Heat Exchanger		All Other Parts	
		Parts	Labour	Parts	Labour
White domestic models	Domestic WITHOUT Rinnai controllers	10 years pro rata	3 years	3 years	3 years
	Domestic WITH a Rinnai controller	12 years pro rata	3 years	5 years	3 years
	Commercial	1,500 hours or 1 year pro rata*	1,500 hours or 1 year*	1,500 hours or 1 year*	1,500 hours or 1 year*
Silver commercial models	Domestic WITHOUT Rinnai controllers	12 years pro rata	3 years	5 years	3 years
	Commercial	5,000 hours or 3 years pro rata*	1,500 hours or 1 year*	1,500 hours or 1 year*	1,500 hours or 1 year*
* Whichever comes first					

### Domestic vs commercial applications

A domestic application is defined as an installation where a continuous flow unit is set to 55 °C<sup>1</sup> or lower, delivering hot water to a single residential dwelling (not used for commercial purposes<sup>2</sup>).

All other installations are defined as commercial applications.

For constant use applications such as, underfloor heating, circulating ring mains, spa pools (but not limited to), the water heater must be sized and installed according to written guidelines from Rinnai.

<sup>1</sup> A solar installation using a Rinnai continuous flow unit in a single residential dwelling is considered a domestic application.

<sup>2</sup> Examples of a commercial application in a domestic dwelling, hair salon, catering kitchen, motel, communal care facility etc.

# Proof of Purchase

---

Please keep these instructions in a safe place for future reference.

RECORD AND ATTACH YOUR PROOF OF PURCHASE BELOW:

Your Retailer: \_\_\_\_\_

Name: \_\_\_\_\_

Address: \_\_\_\_\_

\_\_\_\_\_

Telephone: ( \_\_\_\_\_ ) \_\_\_\_\_

Date of Purchase: \_\_\_\_\_ / \_\_\_\_\_ / \_\_\_\_\_

**Rinnai**

## **WARNING**

Improper installation, adjustment, alteration, service or maintenance can cause property damage, personal injury or loss of life.



For assistance or additional information contact Rinnai on  
0800 RINNAI (0800 746 624).

# Contents

---

About Your Continuous Flow Water Heater	5
Warning About Hot Water	6
General Safety	6
General Information	7
General Controller Information	9
Universal Controller (Compact)	12
Kitchen Deluxe Controller	14
Bathroom Deluxe Controller	16
Troubleshooting	20
Service Record	22
Draining Your Water Heater	24
Installer Details	26

# About Your Continuous Flow Water Heater

---

Congratulations on purchasing the latest technology Rinnai continuous flow water heater.

## Before using or operating your water heater

Ensure the installer talks to you about the use and care of this appliance and that you understand these instructions. The installer also needs to complete:

- their installer details (p. 26)
- the Commissioning Checklist (verifies the water heater has been installed and commissioned correctly) supplied with the appliance

The installer needs to leave the checklist and operation manual with you.



Read these instructions for an overview on what is detailed in this manual about the use, care and servicing of your Rinnai continuous flow water heater.

## Principle of operation

The opening of any hot water tap will automatically start the appliance. Once water is flowing through the appliance the burner will be ignited by electronic ignition.

When the hot water tap is closed and water flowing through the appliance has stopped the burner flame will extinguish.

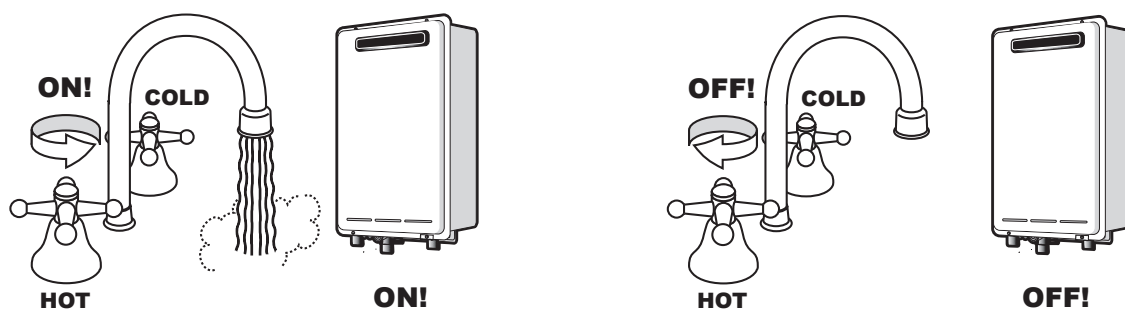

# Warning About Hot Water



Excessively hot water is dangerous. Rinnai continuous flow water heaters through the use of water controllers allow you to control the temperature of hot water to safe levels.

Water temperatures above 55 °C can cause instant severe burns, such as scalding and may even result in death. Those most at risk; children, disabled, elderly, and the sick. Hot water at 65 °C (a common water temperature in New Zealand) can severely burn a child in less than half a second. At 55 °C (preset temperature for domestic Rinnai continuous flow water heaters) it takes a half minute.

## Always

- Test the water temperature with your elbow before placing your child in the bath and feel the water yourself before bathing or showering
- Supervise children whenever they are in the bathroom
- Make sure the hot water tap is turned off

## Consider

Installing child proof tap covers or child resistant taps, both will prevent a child being able to turn on the tap.

## Never

Leave a toddler in the care of another child. They may not understand the need to have the water temperature set at a safe level.

# General Safety

Do not:

- Touch the unit cover or the flue outlet
- Insert objects into the flue outlet

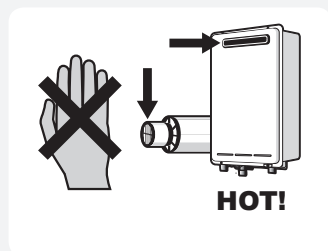

Keep flammable materials, spray cans, fuel containers, pool chemicals, trees, shrubs etc. well clear of the flue outlet.



# General Information

---

## Frost kits



Frost protection is fitted as standard on all models. Frost protection operates automatically (as required) whenever the appliance is connected to the electric power supply.

If power has failed and there is a risk of damage from frost, turn off the gas supply to the unit and open a tap slightly to allow flow through the unit. This may prevent damage from freezing.

If the appliance is not going to be used for an extended period and the electric power supply is disconnected, turn off the water and gas supplies and arrange for your plumber to drain all water from the appliance to prevent frost damage.

If for practical reasons a plumber is unable to drain your system we have an instruction sheet on how to drain the unit at the back of this manual.

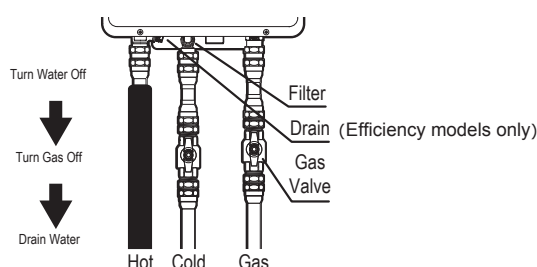

---

## Installation by a licensed tradesperson

Improper installation, adjustment, service or maintenance can cause serious injury, property damage or death. Please ensure your installation is completed by a licensed tradesperson.

---

## Safety devices

Your Rinnai continuous flow water heater has the following safety devices.

- |                             |                                |
|-----------------------------|--------------------------------|
| • Flame failure             | - flame rod                    |
| • Boil-dry protection       | - water flow sensor            |
| • Overheat protection (OHS) | - 97 °C bi-metal switch        |
| • Overheat protection       | - 95 °C lockout thermistor     |
| • Fusible link              | - 129 °C thermal fuse          |
| • Pressure relief valve     | - open 2.1 MPa / close 1.5 MPa |
| • Combustion fan rpm check  | - integrated circuit system    |

# General Information

---

## Servicing



Rinnai has a service and spare parts network with personnel who are fully trained and equipped to give the best advice on your Rinnai appliance. If your appliance needs servicing, please call Rinnai (0800 746 624) from a land line and select **option one** for a service centre in your area.

For reliable operation Rinnai continuous flow water heaters in domestic applications should be serviced every two years (including inspection of the flue system if installed). A service record has been provided at the back of this manual. For commercial applications Rinnai has a recommended Commercial Maintenance and Servicing Schedule. This is available on request or via our technical website - [www.rinnai-tradesmart.co.nz](http://www.rinnai-tradesmart.co.nz).

Regular servicing is not covered by the Rinnai warranty.

Do not attempt to carry out any service work other than that mentioned in the troubleshooting section. If you have any other faults or problems, please refer to your installer or contact Rinnai.

---

## Solar installations

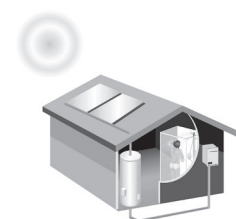

There is a recommended system layout for Rinnai continuous flow water heaters used in solar installations. It is important your installer configures your solar system correctly as water heaters in solar installations produce higher than normal temperatures.

Rinnai water controllers cannot be used with Rinnai continuous flow water heaters in solar installations as the hot water does not always pass through the continuous flow unit.

---

## Temperature limit - factory preset



The Rinnai continuous flow water heaters are factory preset to a temperature limit of 55 °C (excluding one commercial model - Infinity HD200 external).

Temperature controllers are available to allow precise digital temperature control—a great safety feature if you have young children. Controllers can be fitted at any time (except in solar installations) after installation of the hot water unit.

---

## Water flow

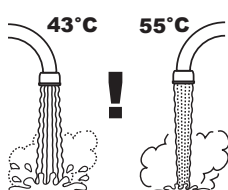

The flow will vary slightly depending on the incoming water temperature and temperature selected. For example the water flow will be higher at 43 °C than at 55 °C.

There is also a minimum flow rate required for the continuous flow unit to start. So if a hot water tap is only opened a fraction there may not be enough flow to start the unit.

---



# General Controller Information

To clean your water controller, use a soft damp cloth and mild detergent.

DO NOT use solvents.

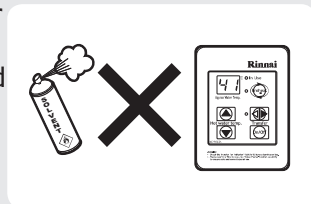

While hot water outlets are open the set temperature may be lowered BUT not raised above 43 °C. Transfer of priority between controllers is not possible. These are safety features.

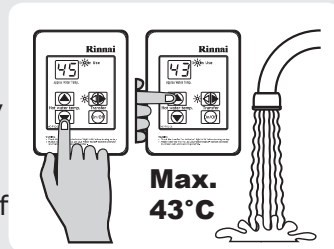

Depending on weather conditions and the length of pipe between the hot water unit and the outlet in use, there may be a variation between the temperatures displayed at the water controller and water outlet.

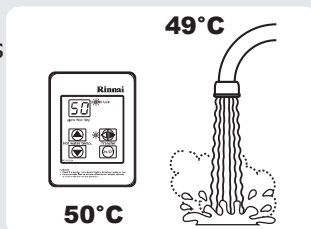

There is no need to turn water controllers off after use.

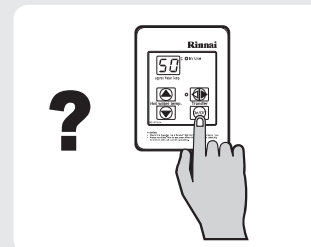

As a safety precaution, if a kitchen controller temperature is set above 50 °C, transferring and then returning priority will result in a default set temperature of 50 °C. This is a safety feature.

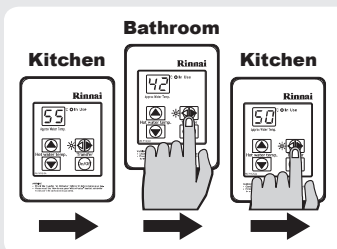

Do not push the On/Off button on any controller when the red water heater 'In Use' indicator is on. This will turn off the water heater causing the water to go cold.

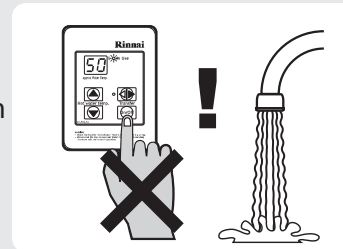

Temperatures higher than 55 °C should not be able to be selected on controllers installed in bathrooms, ensuites or toilets. This is to reduce the risk of burns from hot water. If this is not the case, the controllers have been incorrectly installed and you should contact your installer.



Check the water temperature before use. A parent or carer should ALWAYS check the temperature before a child is placed in contact with hot water.

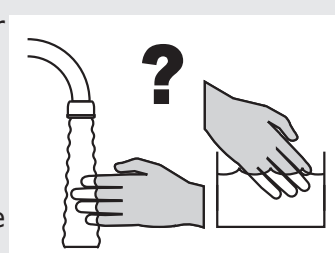

# General Controller Information

Water controllers are an optional extra, they allow precise temperature control (no need to mix hot and cold water). When used correctly, the hot water unit will deliver the selected temperature, even when the water flow is varied, or when more than one tap is use.

Each water controller can be individually programmed, however the water heater can only deliver one set temperature at any time. The available temperatures are as follows.

<b>Kitchen</b>	Domestic Commercial	37, 38, 39, 40, 41, 42, 43, 44, 45, 46, 48, 50, 55 °C 60, 65, 75 °C
<b>Bathroom (hot water)</b>		37, 38, 39, 40, 41, 42, 43, 44, 45, 46, 48, 50 °C
<b>Bathroom (bath fill)</b>		37, 38, 39, 40, 41, 42, 43, 44, 45, 46, 47, 48 °C
<b>Suggested temperatures</b>	Kitchen Shower Bath fill	50 - 55 °C 37 - 43 °C 39 - 45 °C

To obtain water temperatures lower than 37 °C simply add cold water. Maintaining lower temperatures helps save energy.

## Rinnai controllers

- Universal (Compact): temperature selection only
- Kitchen Deluxe: temperature selection and voice prompting
- Bathroom deluxe: temperature selection, shower saver, bath fill and voice prompting
- Wireless: temperature selection only

## Controller configurations

A maximum of four water controllers can be fitted and a combination of wired and wireless controllers can be used with the following limitations:

- Maximum of one Kitchen Deluxe Controller (MC-100V)
- Maximum of two Bathroom Deluxe Controllers (BC-100V)
- Only one controller can be set to deliver 55 °C, this cannot be a Bathroom Deluxe Controller

# General Controller Information

---

## **Controllers need to be turned on for delivery of hot water**

The water heater will not heat water unless the controller(s) are turned on. If water is flowing before a controller is turned on, the water heater will not heat the water. Turn off the tap for a few seconds then turn on again.

## **Ignition problems**

If the water heater fails to ignite, the 'In Use' button will not illuminate. The water heater will not attempt re-ignition until water flow is stopped for a few seconds and then re-started.

When gas bottles have been changed or the gas supply is disrupted (controller may display error code 11 or 12) ignition may fail and the 'In Use' button will not be lit. The water flow may need to be stopped and re-started several times before the appliance will remain alight.

# Universal Controller (Compact)

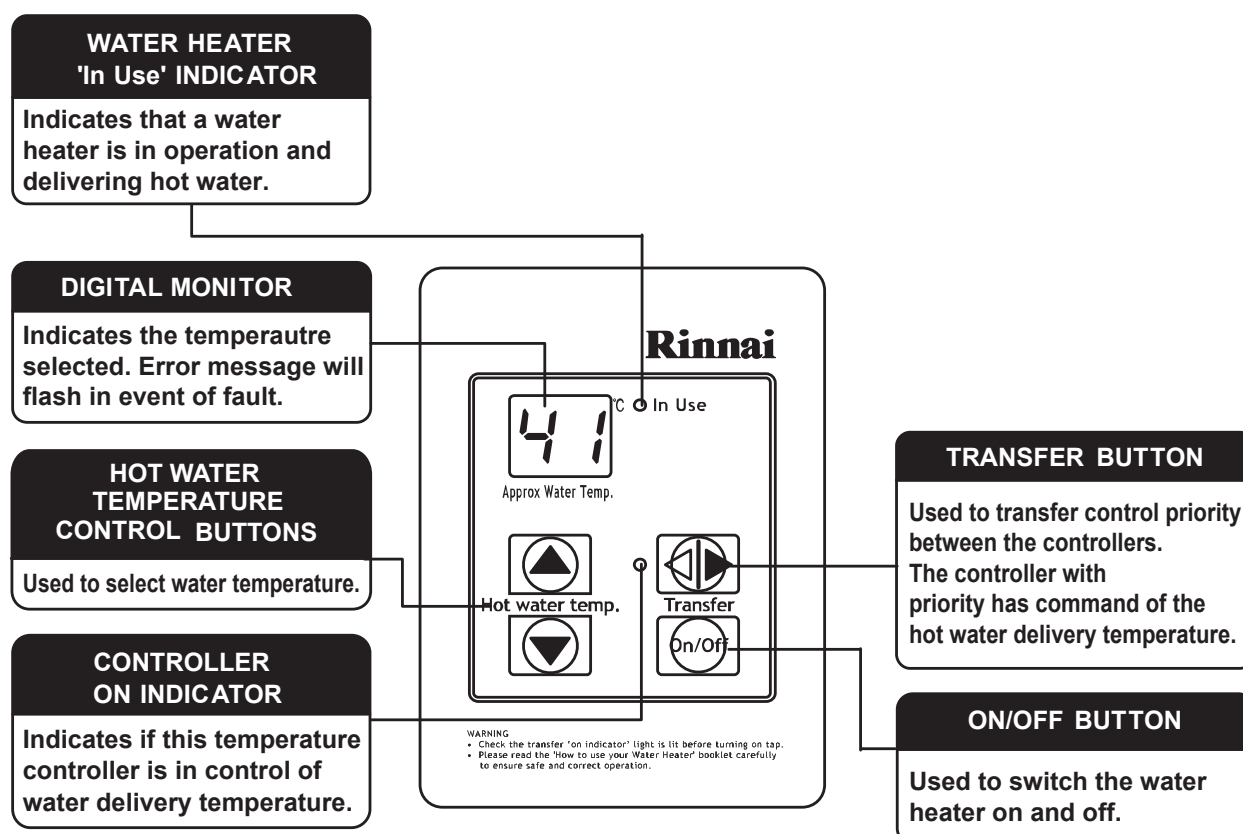

## Turning on

If the water controller is switched off (no digits displayed in the digital window) press the On/Off button once.

The On indicator will illuminate, indicating the continuous flow water heater will be ready to supply hot water once a hot water tap is opened.

## Adjusting the temperature

Select the desired temperature using the 'Hot water temp.' up and down buttons until the required temperature is displayed.

To operate the continuous flow water heater, open any hot water tap. This will automatically light the burner providing hot water. The water heater 'In Use' indicator will illuminate on the water controller.

Once the hot water is running, if the set temperature is either too hot or cold, press the 'Hot water temp.' up or down buttons until the desired temperature is reached.

## Muting the 'beep' sound

The 'beep' sound can be muted by pressing the 'Hot water temp.' up and down buttons simultaneously for more than 3 seconds.

# Universal Controller (Compact)

---

## How to use two or more Universal water controllers

### Turning on

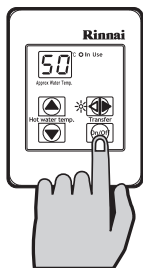

If the controllers are switched off (no digits displayed in the digital window), press the On/Off button once.

The On indicator on the desired controller will illuminate, indicating that the hot water unit will be ready to supply hot water once a hot water tap is opened.

### Transferring priority

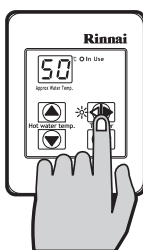

An illuminated On/Off indicator confirms that the desired controller is in control of the water delivery temperature. If the On/Off indicator is not illuminated press the Transfer button once.

The On/Off indicator on the controller will illuminate indicating that the hot water temperature control has been transferred to this controller and that the continuous flow water heater will be ready to supply hot water.

### Adjusting the temperature

Select the desired temperature using the 'Hot water temp.' up and down buttons until the required temperature is displayed. The water heater 'In Use' indicator will illuminate on the water controller.

Once the hot water is running, if the set temperature is either too hot or cold, press the 'Hot water temp.' up and down buttons until the desired temperature is reached.

# Kitchen Deluxe Controller

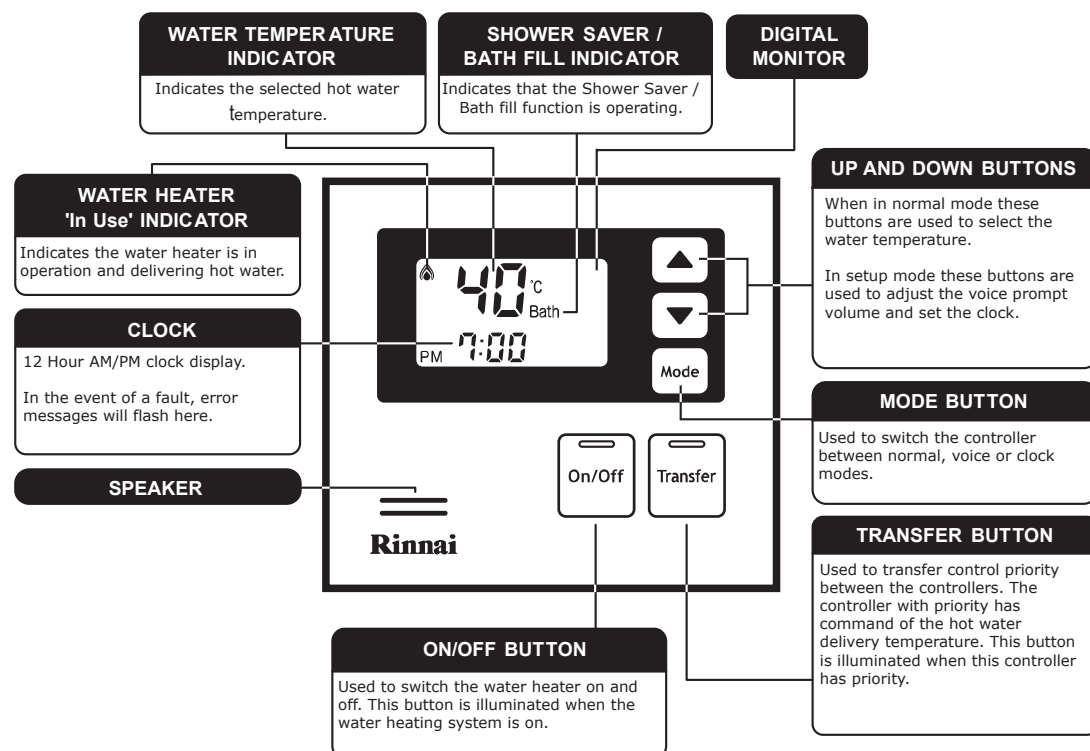

**The Kitchen Deluxe Controller is not water resistant, avoid direct exposure to water or steam as these conditions may cause damage.**

## Turning on

If the water controller is switched off (no digits displayed in the digital window) press the On/Off button once.

The On indicator will illuminate, indicating the continuous flow water heater will be ready to supply hot water once a hot water tap is opened.

If more than one controller is fitted press the 'Transfer' button once to transfer priority to the desired controller.

## Setting the clock

The clock is a 12 hour AM/PM display. To set the time press the 'Mode' button twice. In the digital monitor the word 'Clock' will be displayed and the clock digits will flash, if this is the first time the clock has been set the starting time will be AM 12:00.

Use the up and down buttons to select the desired time. Holding these buttons down continuously cycles the digits. When you get close to the time you wish to set, press the button intermittently to avoid going further than the desired time.

To return to normal mode, press the 'Mode' button once. If no buttons are pressed for approximately 10 seconds the controller will return to normal mode.

The time is always displayed regardless of whether the controller is turned On or Off. The clock may need resetting if power to the water heater is disrupted due to a power failure or if the power is switched off over a prolonged period.

# Kitchen Deluxe Controller

---

## **Setting the sound options**

Voice prompts are only available when Deluxe Bathroom Controllers are installed.

To set the sound options press the 'Mode' button once to place the controller into voice mode. Use the up and down buttons to select the desired audible setting as follows:

- Voice High, Med, Low or off, sets the voice prompt volume but does not affect the 'beep' sound when pressing the buttons.
- Sound Off, mutes all voice prompts and audible tones.

To return to normal mode, press the 'Mode' button once, if no buttons are pressed for approximately 10 seconds the controller will return to normal mode.

## **Adjusting temperature**

Select the desired temperature using the 'Hot water temp.' up and down buttons until the required temperature is displayed.

Once the hot water is running, if the set temperature is either too hot or cold, press the 'Hot water temp.' up and down buttons until the desired temperature is reached.

# Bathroom Deluxe Controller

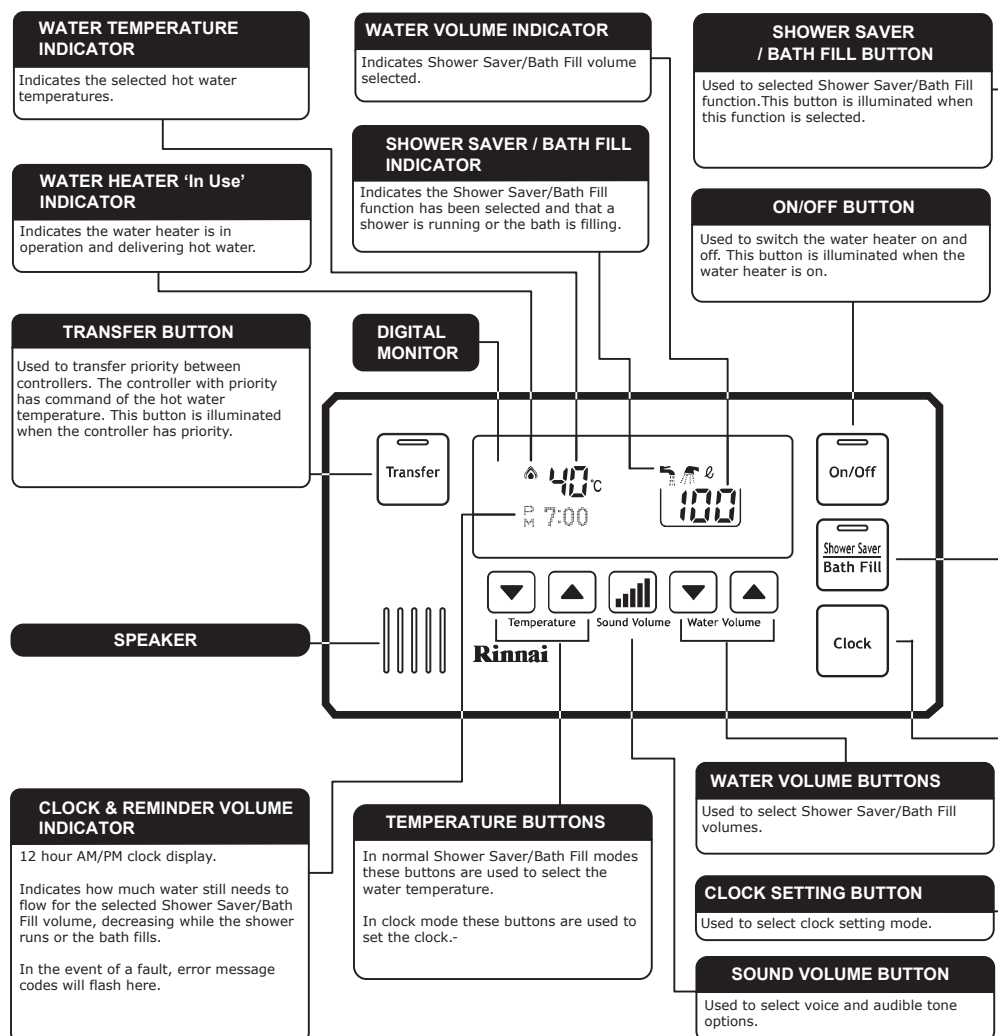

**Avoid getting water directly into the speaker as this may cause damage.**

## Turning on

If the water controller is switched off (no digits displayed in the digital window) press the On/Off button once.

The On indicator will illuminate, indicating the continuous flow water heater will be ready to supply hot water once a hot water tap is opened.

If more than one controller is fitted press the 'Transfer' button once to transfer priority to the desired controller.



# Bathroom Deluxe Controller

---

## **Setting the clock**

The clock is a 12 hour AM/PM display. To set the time press the 'Clock' button once. In the digital monitor the clock digits will flash, if this is the first time the clock has been set the starting time will be AM 12:00.

Use the up and down buttons to select the desired time. Holding these buttons down continuously cycles the digits. When you get close to the time you wish to set, press the button intermittently to avoid going further than the desired time.

To return to normal mode, press the 'Clock' button once. If no buttons are pressed for approximately 60 seconds the controller will return to normal mode.

The time is always displayed regardless of whether the controller is turned On or Off. The clock may need resetting if power to the water heater is disrupted due to a power failure or if the power is switched off over a prolonged period.

## **Setting the sound options**

To set the sound options press the 'Sound Volume' button and select the desired audible setting as follows:

- Voice High, Med, Low or off, sets the voice prompt volume but does not affect the 'beep' sound when pressing the buttons
- Sound Off, mutes all voice prompts and audible tones.

Press the up and down buttons to return to normal mode. If no buttons are pressed for approximately 10 seconds the controller will return to normal mode.

## **Adjusting temperature**

Press the 'Temperature' up and down buttons until the required temperature is displayed.

Once the hot water is running, if the set temperature is either too hot or cold, press the 'Temperature' up and down buttons until the desired temperature is reached.

# Bathroom Deluxe Controller

---

## Operating the shower saver and bath fill

- Initial settings**
- Temperature = 40 °C
  - Volume = 100 litres (range 30 - 400 litres)

### Setting shower/bath temperature and volume

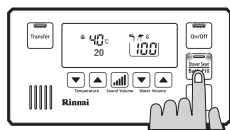

With the system on, select a Deluxe Bathroom Controller. If it does not have priority, press the 'Transfer' button once and the 'Transfer' button will illuminate.

Press 'Shower Saver/Bath Fill' button once. The button will illuminate and voice prompt and tone will sound. Ensure you have the voice and sound turned on.

To select the desired delivery temperature use the 'Temperature' up and down buttons. The selected temperature will be displayed on the digital monitor and will remain as the default 'Shower Saver/Bath Fill' temperature until it is changed or if the mains power is turned off for an extended period.

When filling a bath for the first time, it is recommended that a low bath fill volume such as 60 litres or lower be used. During subsequent bath fills the volume can then be adjusted to suit your known bath volume or desired fill level.

A volume counter (to highlight remaining volume of water to be delivered) displays on the controller below the temperature display (replaces the clock during 'Shower Saver/Bath Fill' operation).

### When filling the bath or if the water has been turned off



Be careful not to overfill the bath, an average bath volume is 160 litres. It is recommended that when filling a bath for the first time you should:

- remain by the bath during the filling process
- use a low bath fill volume such as 60 litres or less

If the water is turned off for any reason and there is less than half the volume of the set amount of water delivered, the 'Shower Saver/Bath Fill' will reset itself and deliver the full set amount when turned on again.

*For example:*

Bath fill is set to 160 litres, it delivers 50 litres and for some reason the water is turned off. When turned on again, the bath fill will reset itself to deliver the full 160 litres, so the bath volume will be 50 litres plus 160 litres.

# Bathroom Deluxe Controller

---

## **Using shower saver/bath fill**

Press the 'Shower Saver/Bath Fill' button once. The button will illuminate and a voice prompt and tone will sound. During 'Shower Saver/Bath Fill' operations the 'Bath' indicator will also be displayed on the Kitchen Deluxe Controller digital monitor (when fitted).

The voice prompt will say "The hot water system is ready. Open the hot water tap". Open the hot water tap for the shower or bath.

The 'In Use' indicator will illuminate on all deluxe water controllers and the shower will run or the bath will start to fill.

## **To stop shower saver/bath fill operations**

If you wish to stop the water flow while the shower saver/bath fill function is in operation, press the 'Shower Saver/Bath Fill' button. The button will flash and the voice prompt will say "Hot water is not available. Turn off all hot water taps and push the 'Bath Fill' button". Follow the voice prompt instructions.

## **When the shower saver/bath fill operation finishes**

Once the shower saver/bath fill operation finishes, the following occurs:

1. Flow from the shower/bath hot water tap stops.
2. 'Shower Saver/Bath Fill' button will flash.
3. Kitchen Deluxe Controller (if fitted) 'Bath' indicator will flash.
4. A tone will sound.
5. The voice prompt will say "Bath fill is complete. Turn off the bath hot water tap and push the 'Bath Fill' button."

Follow the voice prompt instructions. Note, the water heater will not allow hot water to flow from any fixture until the 'Shower Saver/Bath Fill' button has been pressed.

## **Using multiple controllers**

The water heater can be turned on and off at any water controller. If more than one controller is fitted, press the 'Transfer' button to transfer priority to the desired water controller.

# Troubleshooting

## With controllers or status monitor

Your Rinnai continuous flow water heater has a self diagnostic capability. If a fault occurs, an error code will flash on the digital monitor (if you have water controllers) or status monitor (selected models only). This assists with diagnosing the fault and may enable you to overcome a problem without a service call. Please quote the code displayed when contacting Rinnai.

Common Error Codes	Fault	Possible Solution
-	Noticeable reduction of water flow.	Inlet water filter needs to be cleaned. Service call.
03	Power interruption during bath fill, water will not flow when power is back on.	Turn off all hot water taps and press On/Off twice.
10	Air intake or flue blocked.	Service call.
11	No ignition, no gas supply.	Check gas is turned on at water heater and gas meter or cylinder.
12	Flame failure, low gas flow.	Check gas is turned on at water heater and gas meter or cylinder. Check there are no obstructions to the flue outlet.
14	Over heat thermal fuse.	Service call.
16	Over temperature warning.	Service call.
32	Outgoing water temperature sensor faulty.	Service call.
33	Heat exchanger outlet sensor faulty.	Service call.
52	Gas modulating valve faulty.	Service call.
61	Combustion fan failure.	Service call.
65	Water flow control faulty (does not stop flow properly).	Service call.
71	Microprocessor failure.	Service call.
72	Microprocessor failure.	Service call.
LC (00)	Scale build-up in heat exchanger (when checking maintenance code history, 00 is substituted for LC)	Service call.

In all cases you may be able to clear the error code by turning the hot water tap off, then on again. If this does not clear the error code, try pushing the On/Off button Off, then On again. If the error code remains, contact Rinnai for advice.

## Without controllers

Fault	Possible Solution
Unit does not start.	Check power is on at the unit. Check gas isolation valve at the unit and gas meter are fully open.
Units starts and then shuts down immediately.	Check power is still on. Check gas isolation valve at the unit and gas meter are fully open. Open your hot water tap fully.
Unit starts then water goes cold.	Check power is still on. Open your hot water tap fully.

Faults caused by insufficient gas supply, insufficient water supply, gas quality, water quality, installation errors or operation errors are not covered by the Rinnai warranty.

This page has been intentionally left blank

# Service Record

Model:  
Serial #:



<b>Service 1</b>	Date _____
Company _____	
Address _____	
_____	
Phone _____	
Contact _____	
Comments _____	
_____	

<b>Service 2</b>	Date _____
Company _____	
Address _____	
_____	
Phone _____	
Contact _____	
Comments _____	
_____	

<b>Service 3</b>	Date _____
Company _____	
Address _____	
_____	
Phone _____	
Contact _____	
Comments _____	
_____	

<b>Service 4</b>	Date _____
Company _____	
Address _____	
_____	
Phone _____	
Contact _____	
Comments _____	
_____	

<b>Service 5</b>	Date _____
Company _____	
Address _____	
_____	
Phone _____	
Contact _____	
Comments _____	
_____	

<b>Service 6</b>	Date _____
Company _____	
Address _____	
_____	
Phone _____	
Contact _____	
Comments _____	
_____	

<b>Service 7</b>	Date _____
Company _____	
Address _____	
_____	
Phone _____	
Contact _____	
Comments _____	
_____	

<b>Service 8</b>	Date _____
Company _____	
Address _____	
_____	
Phone _____	
Contact _____	
Comments _____	
_____	

# Service Record - Parts Replaced

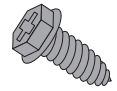

Unit	Run Hours / Ignition Cycles	Part Replaced	Reason	Date	Company
All parts must be replaced with genuine replacement parts available from Rinnai.					

# Draining Your Water Heater



Frost protection is fitted as standard on all models manufactured from 2010 onwards. Frost protection operates automatically (as required) whenever the appliance is connected to the electric power supply.

If you live in an area prone to frost, have an external continuous flow unit, and will be away for an extended period with the power supply disconnected, Rinnai recommend draining your appliance to prevent frost damage (not covered by warranty).

We strongly recommend having your water heater drained by a plumber or gas fitter but understand that remote locations and cost may prohibit this.

## About this document

These instructions are intended as a guide only. Rinnai will not accept liability for issues arising from the use of this information. In particular Rinnai will not be responsible for damage caused by water freezing where this procedure was followed and sufficient water failed to drain from the unit.

## Instructions

### You will need



A bucket if water cannot be drained into a garden or drain



Approximately 15 minutes to complete



To avoid burns wait until the water heater cools before draining the water as hot water may drain from the unit if there has been recent hot water use.

1. Turn off the water, gas and power at the unit. Also turn off any water controllers in the building.

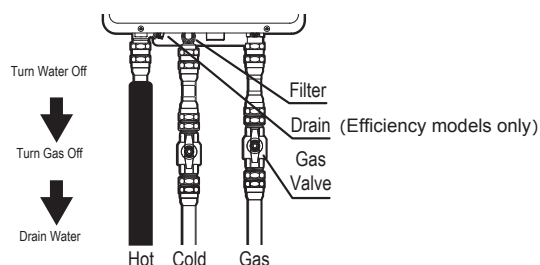

2. Turn on the lowest or furthestmost hot water tap from the appliance. If you want to flush your entire pipe work as well as the water heater, open all hot water taps in the building.



# Draining Your Water Heater

**Line drawing showing the different connections underneath a continuous flow unit**

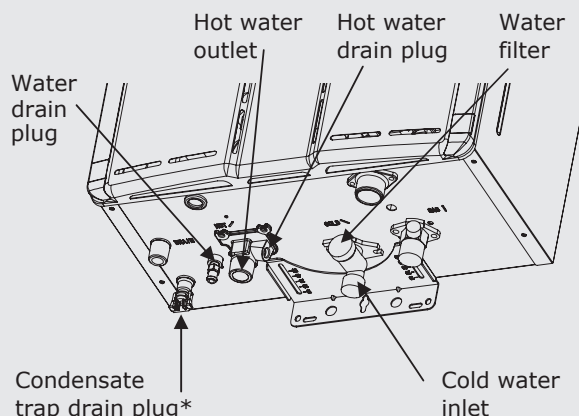

\* Condensate trap drain plug—Efficiency models only. Wash hands after dealing with condensate as it is mildly acidic.

**Photos highlighting connections that need to be drained**

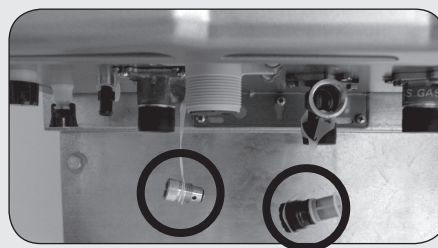
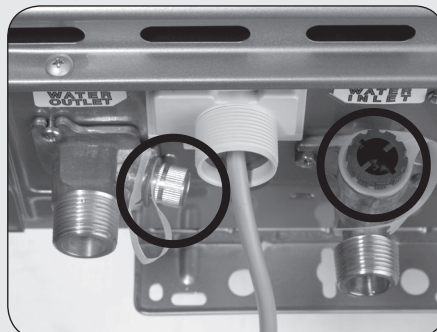

3. If required, place bucket under the unit and unscrew the water filter and hot water drain plug. If you have an Efficiency continuous flow water heater you will also need to unscrew the condensate trap drain plug.
4. Drain the water heater (can hold up one litre of water) and surrounding pipes. Once drained, screw back in the connections from step 3.

## Re-filling your water heater

1. Turn off any open hot water tap(s).
2. Turn on the cold water at the continuous flow water heater.
3. Turn on the hot tap to purge air from the pipe work and unit. You will hear when this has finished.
4. Turn off the hot tap.
5. Turn on the gas and power at the continuous flow water heater and turn on any temperature controllers in the building.

## When the water heater or external pipes have frozen

DO NOT operate the water heater if it or the external pipes have frozen. Close the gas and water valves and turn off the power. Wait until the water thaws, check this by opening the water supply valve.

Check the water heater and pipes for leaks.

# Installer Details

---

Company name: \_\_\_\_\_

Installer name: \_\_\_\_\_

Address: \_\_\_\_\_

\_\_\_\_\_

Phone: \_\_\_\_\_ Mobile: \_\_\_\_\_

Certificate of Compliance number for installation: \_\_\_\_\_

Signed: \_\_\_\_\_ Date: \_\_\_\_\_

**Installer**, please remember to complete and leave the Commissioning Checklist with the customer.





<b>Consumers:</b>	0800 RINNAI (746 624)
<b>Installers:</b>	0800 TO RINNAI (86 746 624)
<b>Address:</b>	105 Pavilion Drive, Airport Oaks, Mangere, Manukau PO Box 53177, Auckland Airport, Manukau 2150
<b>Phone:</b>	(09) 257 3800
<b>Fax:</b>	(09) 257 3899
<b>Email:</b>	<a href="mailto:info@rinnai.co.nz">info@rinnai.co.nz</a>
<b>Websites:</b>	<a href="http://www.rinnai.co.nz">www.rinnai.co.nz</a> and <a href="http://www.rinnai-tradesmart.co.nz">www.rinnai-tradesmart.co.nz</a>

All Rinnai appliances meet or exceed the safety standards required by New Zealand gas and electrical regulations.

Rinnai is constantly improving its products and as such information and specifications are subject to change or variation without notice.



**U287-2778(00)**