

Rinnai

Symmetry Granite outer frame installation

The Symmetry black granite surround kit (R3620) is supplied in four pieces and includes the black inner frame. The granite frame is suitable for all Symmetry models.

During installation it is advisable to have an extra pair of hands to assist. The length and weight of the granite pieces, as well as the quick bonding adhesive, can be tricky to work with. Installation can be completed by the homeowner if they have the required DIY skills.

R3620 kit includes:		Installer to supply:
Horizontal granite frame	x 2	Adhesive and applicator gun
Vertical granite frame	x 2	Packers
Heat deflector	x 1	Measuring tape
		Pencil and rubber
		Spirit level

Dimensions are in mm

Total weight of frame once installed - 20 kg

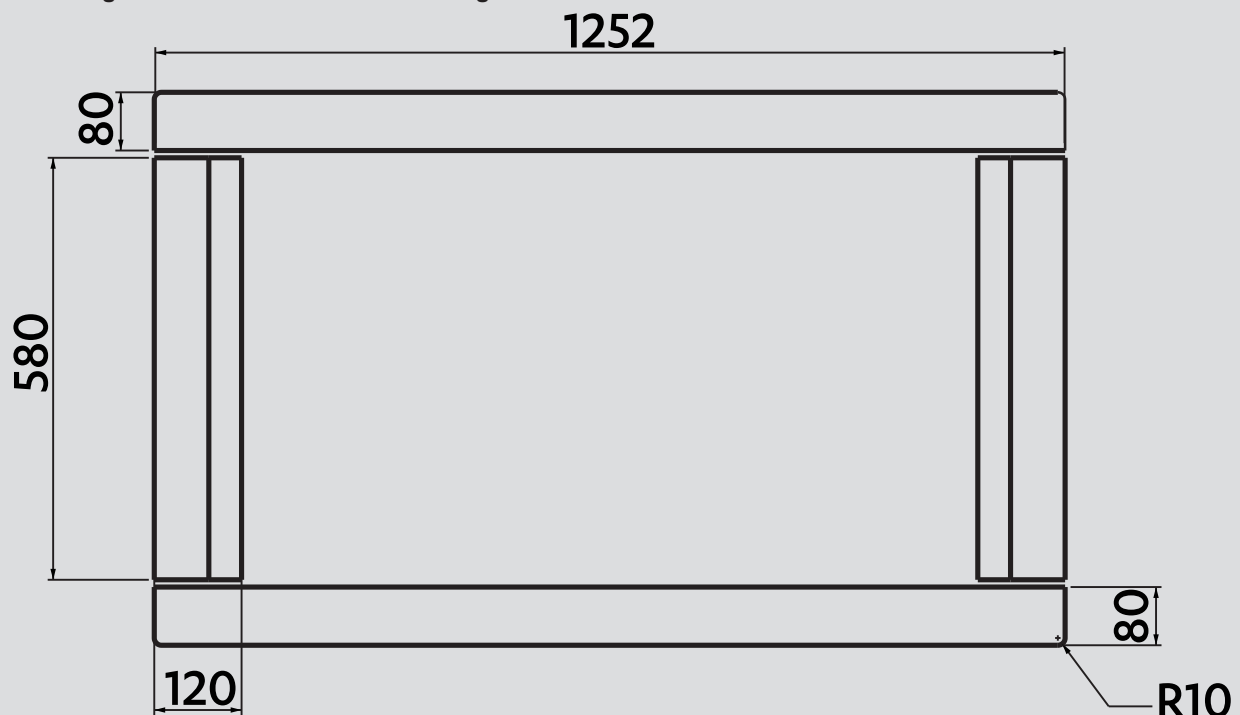

If installing the granite frame on a Symmetry mounted at floor level there will be approximately a 15 mm gap from the underside of the granite frame to the floor.

Before installation

Ensure the following before starting:

- Wall is flat and square, if uneven there will be gaps behind the frame
- Surrounding surfaces that the granite frame will be glued to are clean and dust free
- Surface above the fire has been appropriately sealed and plastered to a smooth finish
- Installation brackets are in the front most position and the wall lining / drywall are finished to the inner edge of the framing plate

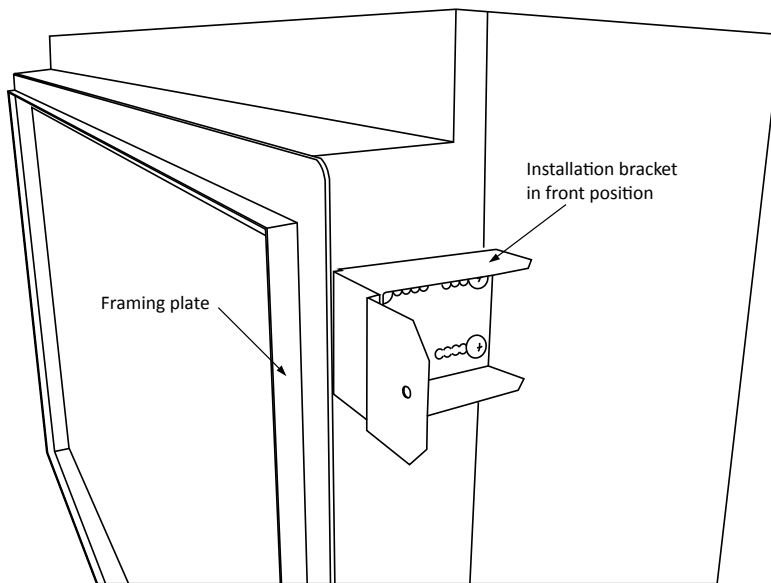

- Adhesive is the appropriate industrial strength and has good 'green' strength, grabs quickly and able to withstand a temperature of up to 120 °C
- Correct position of granite pieces—polished sides face out and side sections have the angled edges facing inwards, refer line drawing on front page.

Installation

1. Mark positions

Mark out with a pencil the side positions of the granite. This will help keep everything square.

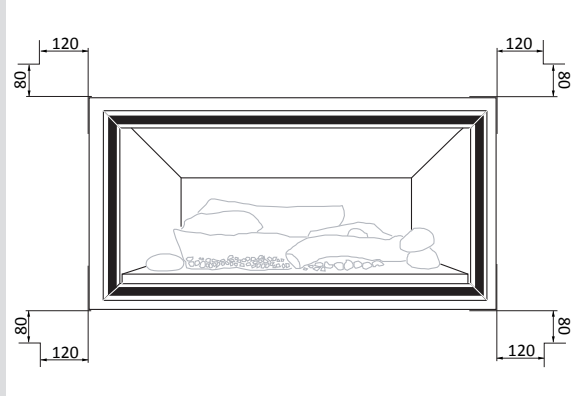

2. Apply adhesive

Begin with the bottom piece and apply adhesive to the back edge. Aim for small narrow lines, thick lines will cause the frame to sit out from the wall.

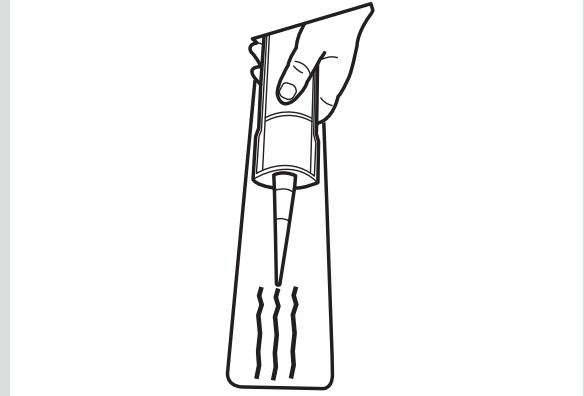

3. Fix bottom piece in place

Using packers, move the bottom piece into position. The top edge should finish flush with the framing plate. Apply pressure by hand to fix in place. Leave overnight so the adhesive can cure.

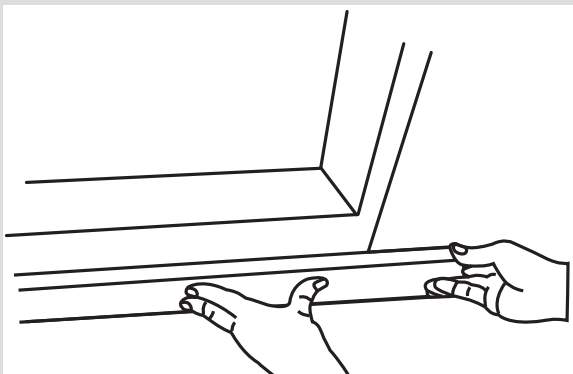

4. Install side granite pieces

Following steps 2-3, including leaving overnight, install the side granite pieces.

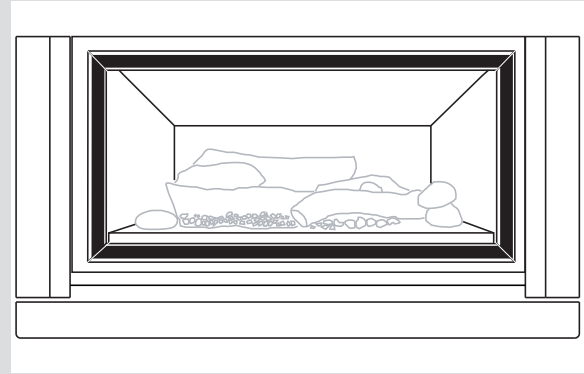

5. Install heat deflector

Install the heat deflector (stops the granite from becoming too hot by deflecting the hot air that rises directly above the unit), by slotting the vertical fold behind the framing plate. The edge of the deflector should sit in the middle of the side granite pieces.

Heat deflector, edges are positioned in the middle of the side granite sections

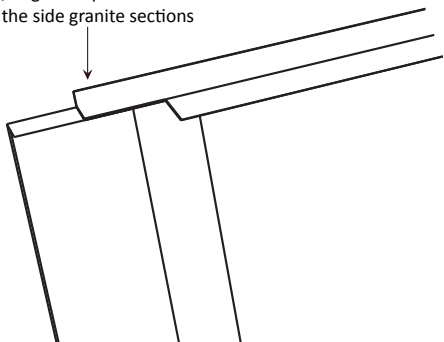

4. Install top granite piece

Following steps 2-3, including leaving overnight, install the top granite piece.

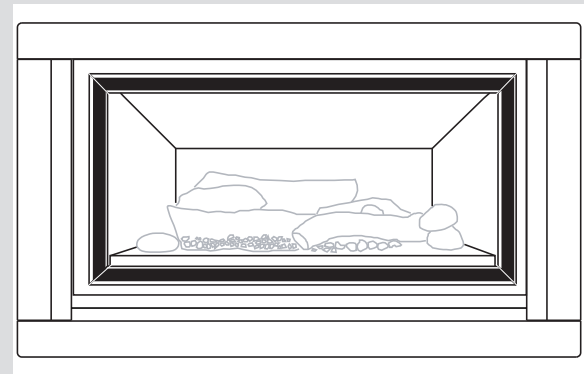

Rinnai.co.nz

Tel: 0800 746 624
<http://www.youtube.com/rinnainz>
<http://facebook.com.rinnainz>

Symmetry granite frame installation 11680-B