

Pro Series R32 Ducted 11 kW indoor unit (DINLR11B1)

This diagram is provided to assist you to identify parts if replacement is necessary. Contact your place of purchase or the manufacturer to enquire about parts, availability and/or service.

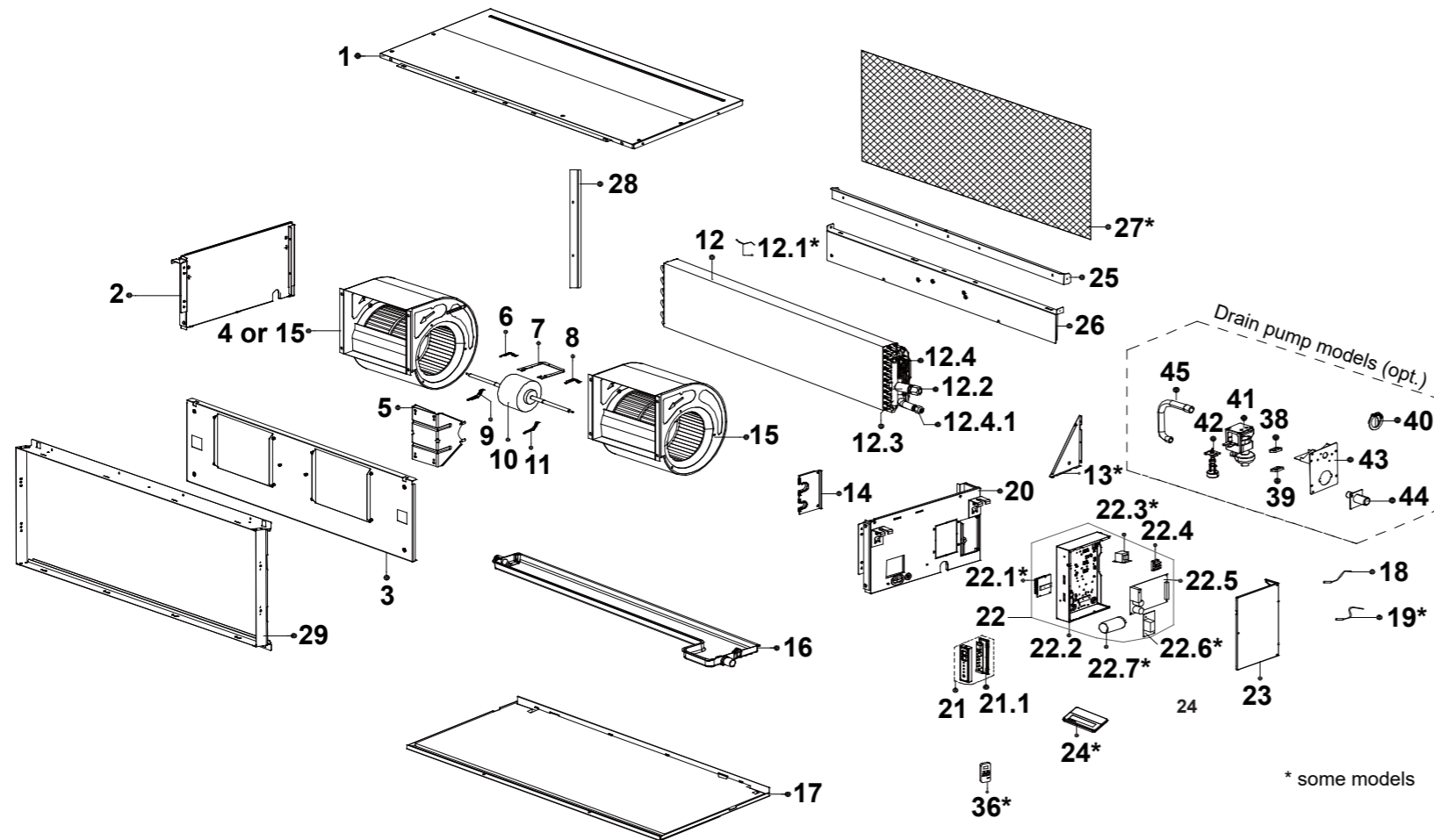

* some models

Ref.	Description (ID)	Part No.
1	Top cover assembly	12223000A02171
2	Left side plate assy. of cabinet	12223000A02174
3	Front clapboard assembly	12223000000139
5	Fan motor support	12223000000560
6	Fan motor cover	12223000000532
7	Fan motor fixing board	12223000000535
8	Fan motor cover	12223000000531
9	Fan motor cover	12223000000530
10	Brushless DC motor	11002015003861 14199

Ref.	Description (ID)	Part No.
11	Fan motor cover	12223000000529
12	Evaporator assembly	15823000004604
12.1	Pipe temperature sensor	11201007000047 84000019
12.3	Evaporator outlet pipe assy.	15123000000304
12.4	Evaporator inlet pipe assy.	15123000011188
14	Pipe clamp board sub-assy.	12223000A02175
15	Fan assembly	12200101000005
16	Water collector assembly	12123000000009
17	Air duct bottom assembly	12223000A02180

Ref.	Description (ID)	Part No.
18	Room temperature sensor	11201007000039 84000025
20	Right clapboard assembly	12223000A02849
21	Duct display board sub-assembly	17223000000003 84000085
21.1	Duct display board sub-assembly	17123000002712
22	Duct electronic control box sub-assy.	17223000A07217
22.2	Electronic control box	12223000008007
22.3	Reactor	17400306000055
22.4	Terminal	17400401000023
22.5	Duct main control board sub-assy. (indoor PCB)	17123000A03546 14228
22.6	Inverter module sub-assembly	17122000053868
23	Cover of electronic control box	12223000008009
24	Wired controller	
25	Flange board	12223000000474
26	Flange sub-assembly	12223000000461
28	Flange board	12223000000470
29	Flange sub-assembly	12223000000460
30	Flare nut	15500406000010
31	Flare nut	15500406000003
38	Drain pump rubber washer	12622500000004
39	Drain pump rubber washer	12622500000003
40	Cover of water testing hole	12123000000043
41	Induction pump	11001010000063
42	Water level sensor	11201005000006
43	Exhaust pump sub-assembly	12223000A02732
44	Drain hose	12100510000021
46	Accessory kit	12011600A00310

Pro Series R32 Ducted 11 kW outdoor unit (DONSR11B1)

This diagram is provided to assist you to identify parts if replacement is necessary. Contact your place of purchase or the manufacturer to enquire about parts, availability and/or service.

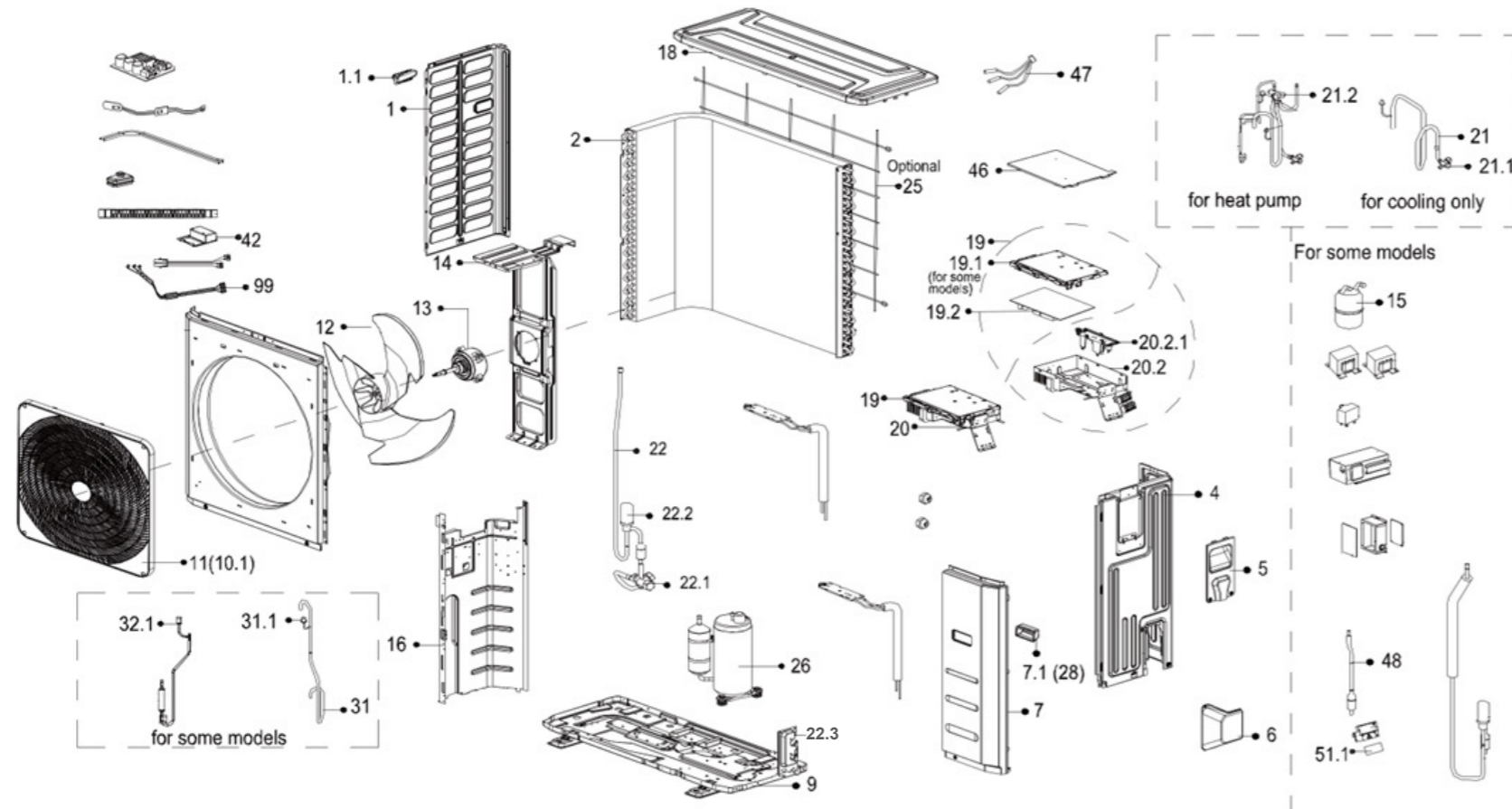

Ref.	Description (ID)	Part No.
1	Left side plate assembly of cabinet	1222200006665
1.1	Small handle	12100701000033
2	Condenser assembly	15822000014415
4	Rear right clapboard assembly	12222000006664
5	Big handle assembly	12222000013365
6	Water collector	12122200002695
7	Front right clapboard assembly	12222500A00135
7.1	Handle	12100702000038
9	Chassis assembly	12222000004018
10	Front panel	12222000004983
11	Air outlet grille	12122000020245

Ref.	Description (ID)	Part No.
12	Axial flow fan	12100105000084
13	Brushless DC motor	11002015000247
14	Fan motor support sub-assembly	12222000005162
15	Liquid storage tank	15500508000002
16	Partition board assembly	12222000012328
18	Top cover assembly	12222500000587
19	Electronic control box sub-assembly	17222000036014
19.1	Electronic control box cover	12122000025662
19.2	Outdoor main control board sub-assembly	17122000053863
20	Terminal board sub-assembly	17222000036015

Ref.	Description (ID)	Part No.
20.1	Terminal	17400401000075
20.2	Electronic installing box sub-assembly	12222000012985
20.2.1	U-typed support with copper tube	12122000024381
21	4-way valve assembly	15422500000236
21.1	Gas valve	15500204000025
21.2	4-way valve	15500216000681
21.4	Suction pipe	15123000008207
21.5	Discharge pipe	15123000003661
22	Liquid valve assembly	15422000020353
22.1	Liquid valve	15500208000286
22.2	Electronic expansion valve body	15500213002289
22.3	Valve plate	12222200002110
24	Flare nut	15500406000003
24	Flare nut	15500406000010
25	Rear net	12222000006604
26	DC inverter rotary compressor	11103020000719
31	Suction pipe assembly	15122500001076
31.1	Pressure switch	17400516000848
32	Discharge pipe assembly	15122000028897
32.1	Pressure switch	17400516000849
42	DR module box sub-assembly	17222300002768
43	Radiator sub-assembly	15122000026020
46	Electronic control box cover	12122000016029
47	Combination sensor	11201011000188
48	Throttle valve sub-assembly	15422000020352
51	Key board box sub-assembly (not shown)	17222000031403
51.1	Key board sub-assembly	17122000048520
53	Outdoor unit name plate	16022000C11074
99	Compressor wire sub-assembly	16022000C11074