

# Mains pressure retrofit thermostat kit (30016) installation overview

## Background

Pre-2009 TSR/TSE thermostats, pictured, are no longer manufactured and can be replaced using the mains pressure retrofit thermostat kit shown below.



## Kit contents



Sticker and template

Fittings pack

Thermostat

Element cover

## Installation overview

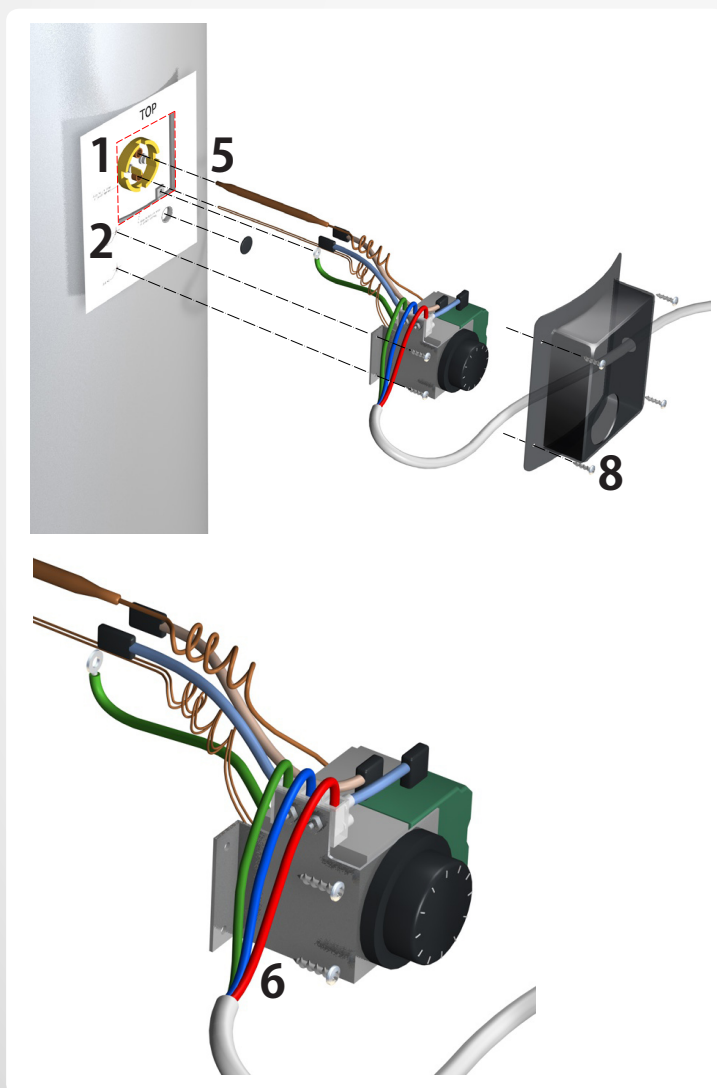

1. Line up template with square hole.
2. Drill  $\varnothing 2.0$  holes—no deeper than 25 mm.
3. Remove template.
4. Mount thermostat with the screws provided.
5. Insert probes. The thermostat probe (has a bulb end) goes in the top, and the over-temperature protector goes in the bottom.
6. Fit wires to the terminal block.
7. Drill holes as in step 2, using the element cover as a template—holes no deeper than 25 mm.
8. Mount the element cover and attach the sticker provided.