

# Rinnai Infinity pipe cover installation guide

Before installation check for damage (do not install any damaged items), check all components have been supplied, and read these instructions to get an overview of the steps required before starting.

To suit the following Rinnai Infinity pipe cover kits:

Kit No.	Suitable for
<b>R1385</b>	Rinnai Infinity VT16-VT26 Rinnai Infinity XR16-XR26 Rinnai Infinity VSeries 16-26
<b>R1402</b>	Rinnai Infinity XR32
<b>R1402SC</b>	Rinnai Infinity HD250 and HD250i
<b>R1408</b>	Rinnai Infinity EF24
<b>R1408SC</b>	Rinnai Infinity HD200 and HDi200

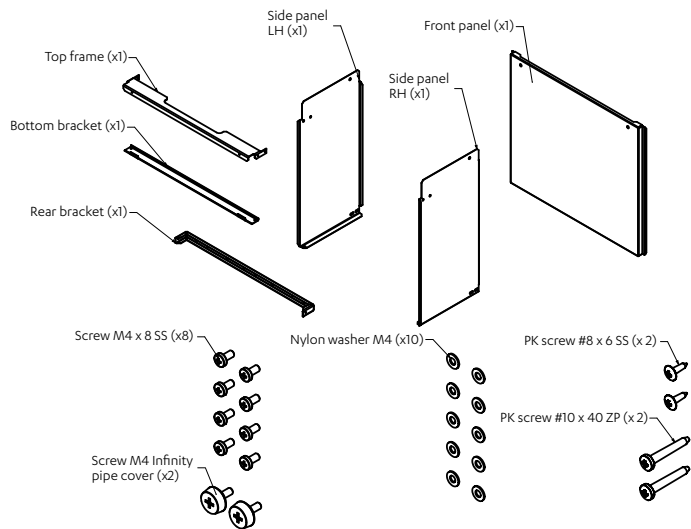

## Important

Before installing the pipe cover turn off the power, water, and gas to the water heater.

If installing a pipe cover for an older model water heater (Rinnai Infinity XR or VSeries model) the front cover of the water heater and PCB will need to be removed. These models do not have predrilled holes for the pipe cover and there is a risk of damage to the PCB when drilling through the unit to attach the pipe cover.

## Initial assembly

1. Assemble the top frame to the right and left side panels with four M4 screws and washers.
2. Secure the bottom bracket to the left and right panels with two M4 screws and washers.
3. Secure the rear bracket to the left and right panels with two M4 screws and washers.

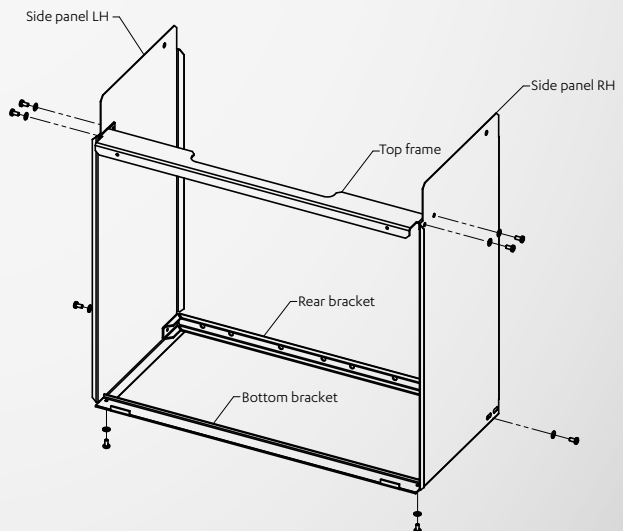

### Pipe cover installation

1. Fit the pipe cover to the water heater using the two short stainless steel PK screws and nylon washers.
2. If an XR or VSeries model refit the PCB and front cover onto the water heater.
3. Use the #10 x 40 ZP PK screws to fasten the rear bracket to the wall. Use suitable anchors for the wall if required (not supplied).

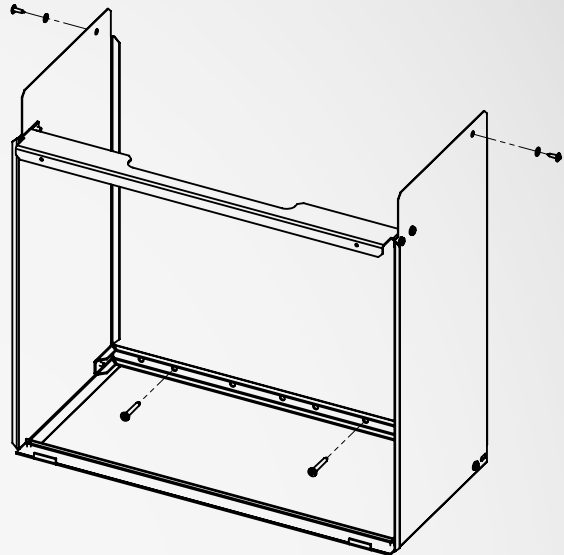

### Fitting the front panel

1. Fit the two slots in the lower edge of the front panel onto the tabs of the bottom bracket.
2. Use the two M4 Infinity pipe cover screws (M4 plastic capped thumbscrews) to fasten the front panel to the top frame.
3. Turn on power, water, and gas to the water heater and test before leaving.

